

ETEKT+ IMPROPER OPERATING CONDITIONS

The ETEKT+ is the only thing that should be in contact with the glass while the reading is being taken. The operator may have their hand on the meter itself, but should not allow any part of their hand to overlap the meter and come into contact with the glass during testing.

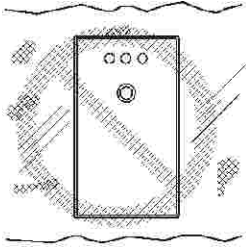

If the window area under test is excessively dirty or contaminated, the ETEKT+ will give improper results. The window area under test must be **RELATIVELY CLEAN**. Clean the test area or move the ETEKT+ to a clean location on the window.

The ETEKT+ must be used with the surface opposite the "Activate" button against the window. Using the small end surface of the unit or tilting the unit away from the surface will give improper results.

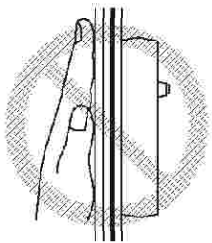
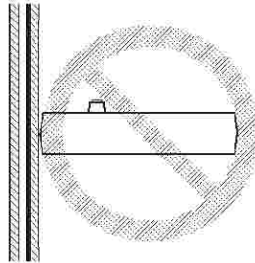

Placing the hand or an object on the window opposite the ETEKT+ may give improper results. Remove hand or object.

IMPORTANT:

Do not operate ETEKT+ within two (2) inches of a window frame or any other metallic window component. Operating the unit in this way may give improper results.

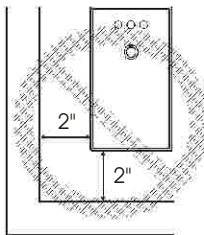

AE1600 WARRANTY

The manufacturer warrants all models of the AE1600 to be free from defects in material and workmanship under normal use and service as specified within the operator's manual. The manufacturer shall repair or replace the unit within twelve (12) months from the original date of shipment after the unit is returned to the manufacturer's factory, prepaid by the user, and the unit is disclosed to the manufacturer's satisfaction, to be thus defective. This warranty shall not apply to any unit that has been repaired or altered other than by the manufacturer. The aforementioned provisions do not extend the original warranty period of the unit which has been repaired or replaced by the manufacturer. Batteries are not covered by warranty.

EDTM, Inc. assumes no liability for the consequential damages of any kind through the use or misuse of the AE1600 product by the purchaser or others. No other obligations or liabilities are expressed or implied. All damage or liability claims will be limited to an amount equal to the sale price of the AE1600, as established by EDTM, Inc.

etekman.cdr

ETEKT+ TM

LOW-E COATING DETECTOR/LOCATOR

MODEL# AE1600

GENERAL DESCRIPTION:

The "ETEKT+" is an instrument which uses a patented method to detect the presence and location of a Low-E coating or any other conductive coating on or within a window assembly. (The ETEKT+ is optimized for SS/DS glass with a 1/2" airspace).

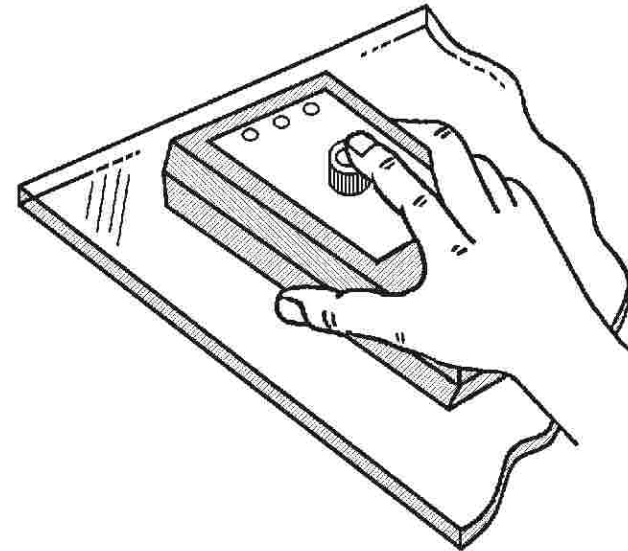

This instrument detects the presence of an electrically conductive coating in/on a window. All Low-E coatings are conductive, unfortunately so is pollution. Make sure the window is reasonably clean. If in doubt about the "Far" surface detection, take a reading from the opposite side of the window. This instrument is factory calibrated and needs no field adjustments. **AT A MINIMUM, PLEASE REPLACE THE BATTERY ANNUALLY WITH A 9-VOLT ALKALINE BATTERY.**

ELECTRONIC DESIGN TO MARKET, INC. (EDTM, Inc.)

745 Capital Commons Drive
Toledo, Ohio 43615 USA

PHONE: (419) 861-1030 FAX: (419) 861-1031
WWW.EDTM.COM Email: sales@edtm.com

KEEP THE COMPETITIVE EDGE WITH PRODUCTS FROM EDTM, INC.

GLASS & AIR SPACE LASER METERS, SOLAR, VISIBLE, & UV METERS
LOW-E DETECTORS, 4 POINT SHEET RESISTANCE METERS, TIN SIDE DETECTORS
MANUFACTURING INSPECTION EQUIPMENT, VARIOUS LAMPS & ACCESSORIES

**SINGLE PANE OR IG WINDOW ASSEMBLIES
CONTAINING SS (3/32") OR DS (1/8") GLASS
--with 1/4" to 1/2" air spacers--**

CONTACTING LOW E INDICATION

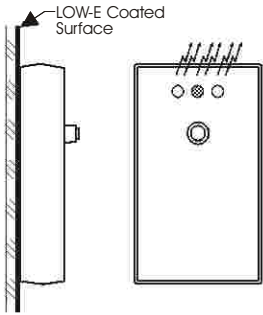

When the ETEKT+ is in direct contact with a LOW-E coating the GREEN, YELLOW and RED indicators will all be lighted. (NOTE: ETEKT+ shown contacting coated surface.)

NEAR INDICATION

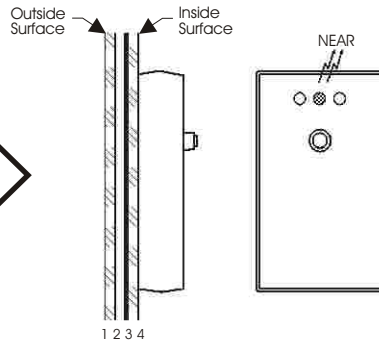

The YELLOW light indicates that a LOW-E coating exists on the NEAR surface of the window. The near surface of the window is surface #3. (NOTE: Coating shown on surface #3).

FAR INDICATION

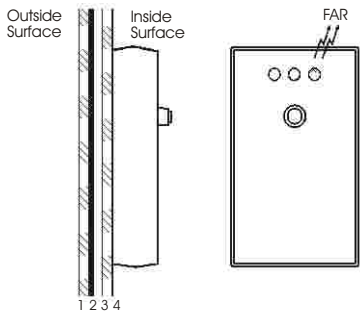

The RED light indicates that a LOW-E coating exists on a FAR surface of the window. The far surfaces of the window are surface #1 or surface #2. (NOTE: Coating shown on surface #2.)

CLEAR INDICATION

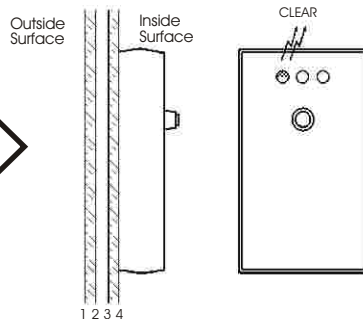

The GREEN light indicates that the window is CLEAR of any LOW-E COATING. NO LOW-E coating exists on surfaces #1, #2, #3 or #4.

"SINGLE PANE MODE"

**SINGLE PANES or IG WINDOWS WITH 3/16" OR 1/4" GLASS,
or SS/DS WINDOWS WITH AIR SPACES GREATER THAN 1/2"**

The ETEKT+ RED/FAR and GREEN/CLEAR lights are optimized for single pane or IG window assemblies manufactured with SS (3/32") or DS (1/8") glass with an air space between 1/4" and 1/2". Whenever you are operating on glass or air spaces outside of this range, DISREGARD the RED and GREEN indicators--they have NO meaning.

For applications with 3/16" or 1/4" glass, as well as SS/DS applications with air spaces greater than 1/2", the AE1600 switches to "Single Pane Mode". In this mode, the detector will only test the first piece of glass in an IG assembly. Therefore, to fully test an IG unit, you must take a reading from both sides of the window, measuring each piece of glass individually, watching for the NEAR/YELLOW indicator. If you do not obtain a NEAR indication on either side of the IG unit, it is a CLEAR IG assembly. If you do obtain a NEAR indication on one side of the window, that piece of glass contains the low e.

**If you do not know the thickness of glass or air space,
follow this procedure**

1. Test both sides of the window looking for the NEAR indication ONLY.
2. If you do not get a NEAR indication on either side of the window, the window does not contain any LOW-E coatings.
3. If the YELLOW/NEAR indicator lights on one of the sides of the window, then that pane of glass contains the LOW-E coating.
4. Totally disregard the FAR and CLEAR indicators, as they are not valid in this application.
5. The "CONTACTING" coating indication is valid for all applications, regardless of thickness or air space.

USABLE LIGHTS FOR 3/16" OR 1/4" GLASS

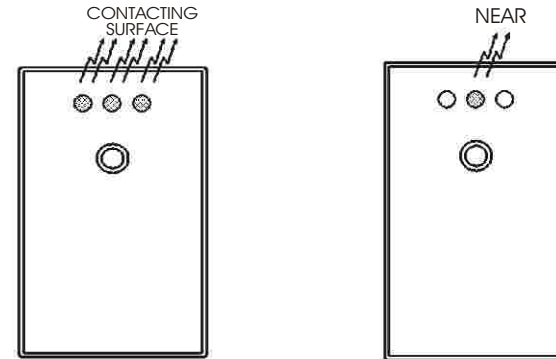

DISREGARD FOR 3/16" OR 1/4" GLASS

